

APPLICATION EXAMPLES



Fixing of railing



Pipe mounting



Wood constructions



Fixing of cable clamp



Screw-In-Anchor



Fixing of mounting rails

The right way to install

1. Drilling
2. Cleaning
3. Screwing
4. Finished

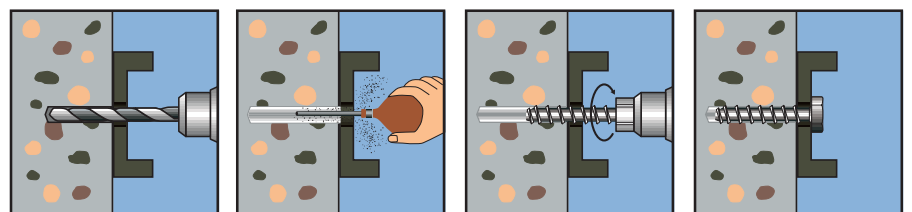



Type: MMS-S hexagon head

Material: steel, hardened

Surface: bright zinc plated

Color code
HECO-Label

Recess: hexagon head

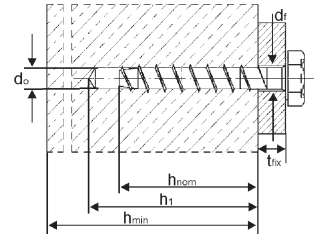

Size D x L [mm]	Article No.	Drill diameter d ₀ [mm]	Clamping strength t _{fix} [mm]	Head diameter [mm]	Recess	Ap- proval	Packing unit [pcs.]	Pieces per outer carton [pcs.]	Pieces per pallet [pcs.]	Gross price [€/100 pcs.]
--------------------	-------------	--	---	--------------------------	--------	---------------	---------------------------	--------------------------------------	--------------------------------	-----------------------------

VARIANTA - BOXES FOR PROFESSIONALS

6,0	40	20218*	5,0	5	10,0	SW-10		200	2.000	96.000	26,00
	50	37111	5,0	5	10,0	SW-10	O	100	1.000	48.000	27,55
	60	37112	5,0	15	10,0	SW-10	O	100	1.000	48.000	29,40
	80	37113	5,0	35	10,0	SW-10	O	50	500	24.000	49,05
	100	37114	5,0	55	10,0	SW-10	O	50	500	24.000	52,60
7,5	35	37115*	6,0	1	13,0	SW-13		100	1.000	48.000	28,85
	40	37116*	6,0	5	13,0	SW-13		100	1.000	48.000	30,70
	45	21214	6,0	1	13,0	SW-13	O	100	1.000	48.000	34,40
	50	20999	6,0	5	13,0	SW-13	O	100	1.000	48.000	34,75
	60	42604	6,0	5	13,0	SW-13	•	100	1.000	48.000	36,40
	80	42606	6,0	25	13,0	SW-13	•	50	500	24.000	59,80
	100	42608	6,0	45	13,0	SW-13	•	50	500	24.000	64,70
	120	42610	6,0	65	13,0	SW-13	•	50	500	24.000	69,50
10,0	140	42612	6,0	85	13,0	SW-13	•	50	500	24.000	86,20
	60	21097	8,0	5	16,0	SW-16	O	50	500	24.000	77,55
	70	44778	8,0	5	16,0	SW-16	•	40	400	19.200	85,25
	80	44775	8,0	15	16,0	SW-16	•	40	400	19.200	90,40
	100	41150	8,0	35	16,0	SW-16	•	25	250	12.000	93,85
	120	41152	8,0	55	16,0	SW-16	•	25	250	12.000	101,95
	140	41154	8,0	75	16,0	SW-16	•	25	250	12.000	109,90
12,0	160	41156	8,0	95	16,0	SW-16	•	25	250	12.000	121,75
	60	37120*	10,0	5	18,0	SW-18		25	250	12.000	95,45
	80	41158	10,0	5	18,0	SW-18	•	25	250	12.000	106,20
	90	41160	10,0	15	18,0	SW-18	•	25	250	12.000	114,05
	100	41162	10,0	25	18,0	SW-18	•	25	250	12.000	117,10
	120	41164	10,0	45	18,0	SW-18	•	25	100	7.200	127,95
	140	41166	10,0	65	18,0	SW-18	•	25	100	7.200	139,55
	160	41168	10,0	85	18,0	SW-18	•	25	100	6.400	153,30

• = according to ETA 05/0010

O = according to the German DIBt-approval no. Z-21.1-1503

*Not qualified for fastenings in case of fire



Type: MMS-S hexagon head with washer DIN 440

Material: steel, hardened

Surface: bright zinc plated

Color code
HECO-Label

Recess: hexagon head

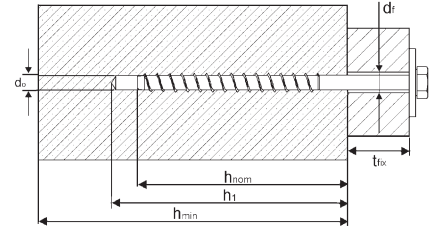

Size D x L [mm]	Article No.	Drill diameter d_0 [mm]	Clamping strength t_{fix} [mm]	Head diameter [mm]	Recess	Ap- proval	Packing unit [pcs.]	Pieces per outer carton [pcs.]	Pieces per pallet [pcs.]	Gross price [€/100 pcs.]
--------------------	-------------	---------------------------------	--	--------------------------	--------	---------------	---------------------------	--------------------------------------	--------------------------------	-----------------------------

VARIANTA - BOXES FOR PROFESSIONALS

12,0	180	42447	10,0	105	18,0	SW-18	•	25	100	6.400	235,90
	200	41170	10,0	125	18,0	SW-18	•	25	100	6.400	247,90
	240	41172	10,0	165	18,0	SW-18	•	25	100	6.400	315,50
	280	41174	10,0	205	18,0	SW-18	•	25	100	4.800	360,65
	320	41176	10,0	245	18,0	SW-18	•	25	100	4.800	405,60

• = according to ETA 05/0010

MM



MULTI-MONTI® stainless steel



PRODUCT INFORMATION

- Fast and easy mounting
- No spreading effect, therefore small spacing and edge distances possible
- Use of power tools is allowed as no tightening torque is required
- European technical approval for MMS-7,5, MMS-10 and MM-12
- DIBt approval for MMS-7,5
- Safe handling, hidden fixation errors are not possible
- Available in stainless steel A5 1.4571 and in stainless steel A4 1.4401
- Stainless steel HCR 1.4529 on request
- Approved for cracked and non-cracked concrete



The innovative screw anchor for concrete and masonry

Head-marking

for easy identification of the anchor

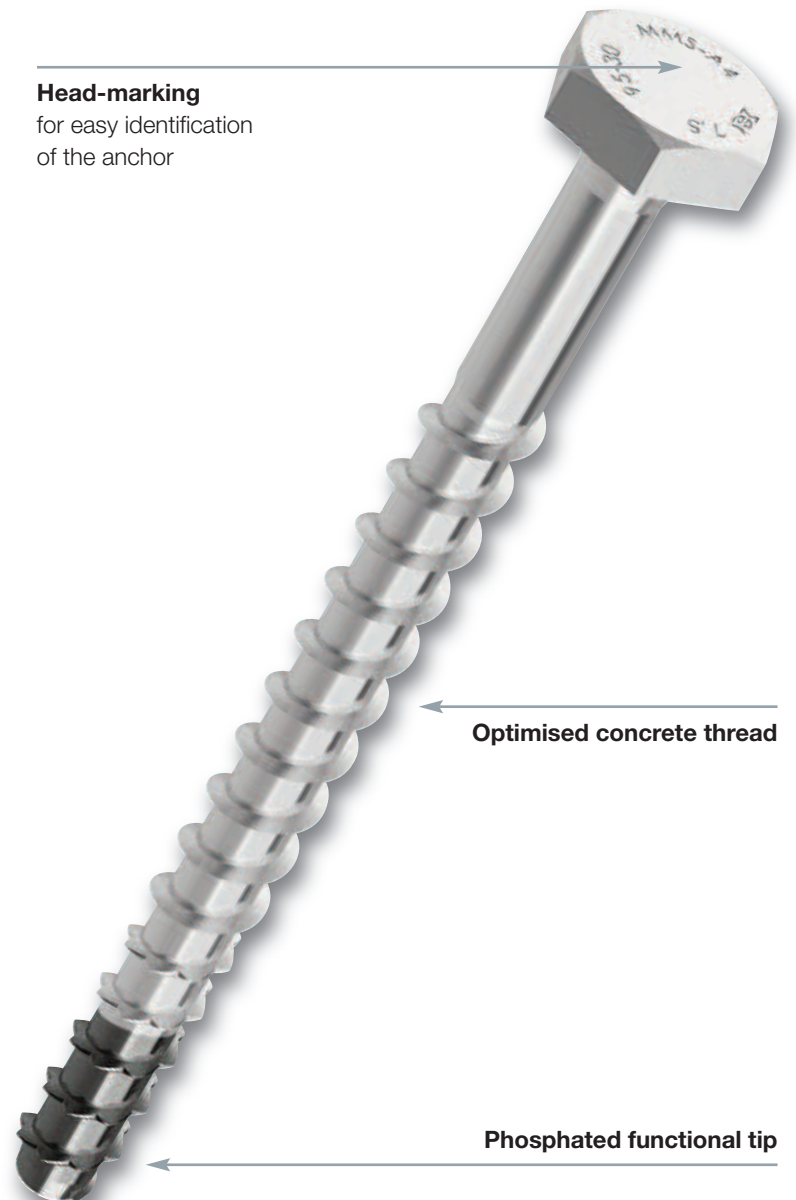

Optimised concrete thread

Phosphated functional tip

